

Highway and Transportation Map

POLK COUNTY IOWA

Prepared By

Iowa Department of Transportation

Phone (515) 239-1289

In Cooperation With

United States Department of Transportation

1986

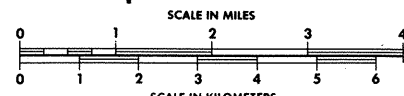

LEGEND

COUNTY LINE	---
CIVIL TOWNSHIP	---
CORPORATION LINE	---
SECTION LINE	---
INTERMITTENT STREAM	---
NARROW STREAM	---
WIDE STREAM	---
HIGHWAY BRIDGE SMALL	---
HIGHWAY BRIDGE LARGE	---
RAILROAD STATION	---
RAILROAD BELOW OVERHEAD	---
RAILROAD OVER SUBWAY	---
RAILROAD SINGLE OPERATING COMPANY	---
RAILROAD ELECTRIC	---
PIPE LINE GAS	---
PIPE LINE OIL	---
STATE CAPITAL	---
CENTER OF CITIES	---
CENTER OF STATE CAPITAL	---
RAILROAD GRADE CROSSING	---
UNIMPROVED ROAD (RURAL)	---
GRADED AND DRAINED ROAD	---
SOIL SURFACED ROAD	---
GRAVEL ROAD	---
BITUMINOUS SURFACED ROAD	---
PAVED ROAD	---
HIGHWAY WITH PARTIAL CONTROL OF ACCESS	---
HIGHWAY WITH FULL CONTROL OF ACCESS	---

LEGEND

AUTO JUNK YARD	---
SANITARY LAND FILL	---
HIGHWAY GARAGE	---
DRIVE IN THEATER	---
RACE COURSE	---
CAMP GROUNDS	---
BOOSTER STATION	---
NURSERY	---
AIRPORT, LIMITED FACILITIES	---

LEGEND

FARM UNIT	---
DWELLING OTHER THAN FARM	---
ROWS OR GROUPS OF DWELLINGS	---
STORE OR SMALL BUSINESS ESTABLISHMENT	---
SCHOOL OR OTHER EDUCATIONAL INSTITUTION	---
CHURCH OR OTHER RELIGIOUS INSTITUTION	---
CEMETERY	---
GAGING OR PUMPING STATION	---
POWER PLANT	---
AIRPORT, COMPLETE FACILITIES	---
CAMP OR LODGE	---
RADIO STATION	---
GOLF COURSE OR COUNTRY CLUB	---
AIRWAY BEACON LIGHT	---
GRAVEL PIT	---
TRIANGULATION STATION	---
COUNTY HOME	---
PICNIC GROUNDS	---
UNITED STATES HIGHWAY	---
STATE HIGHWAY SYSTEM	---
COUNTY HIGHWAY SYSTEM	---
STATE OR FEDERAL PROPERTY (NAMED)	---
DELIMITING AREA (GENERALIZED)	---
FEDERAL AID HIGHWAY SYSTEM	---
POINTS BETWEEN WHICH DISTANCES ARE MEASURED	---
LEGAL ROAD NOT OPEN TO TRAFFIC	---
4-LANE UNDIVIDED HIGHWAY	---
SMALL PARK (STATE/COUNTY)	---
INTERSTATE HIGHWAY	---
DIVIDED HIGHWAY	---
STORY CO.	---

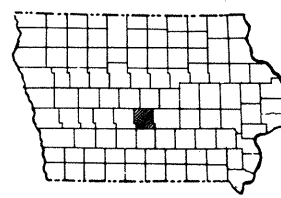
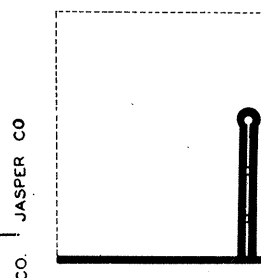
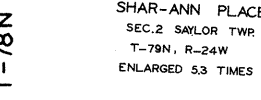
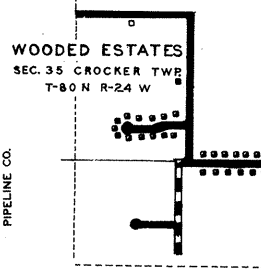
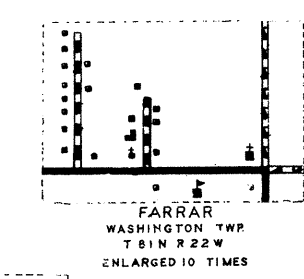
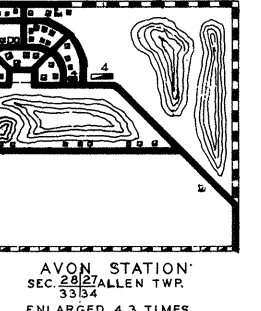
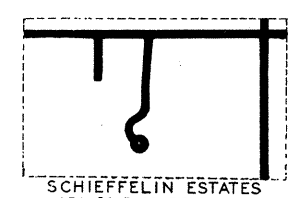
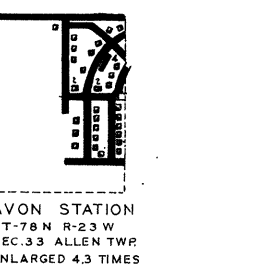
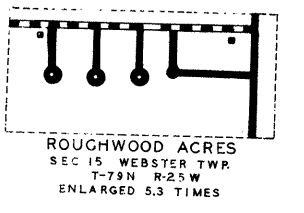
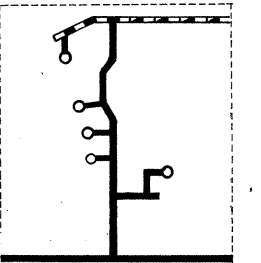
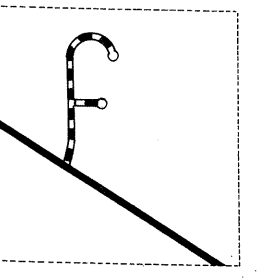
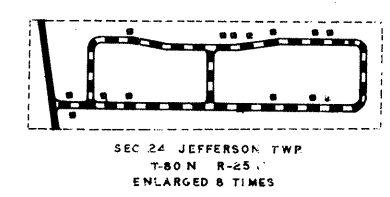
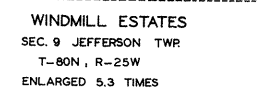
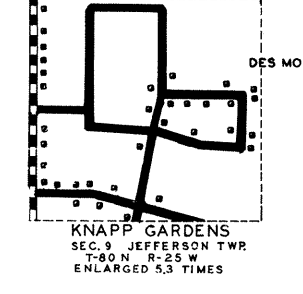
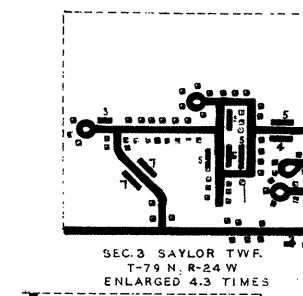
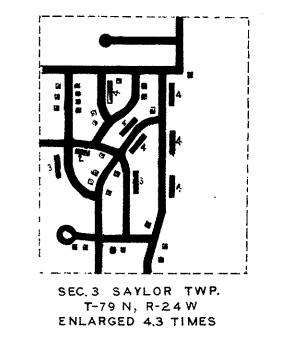
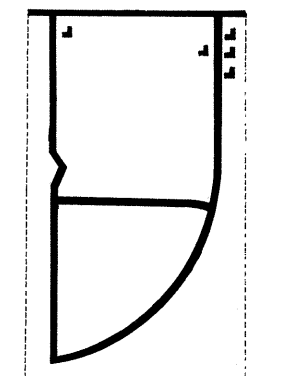
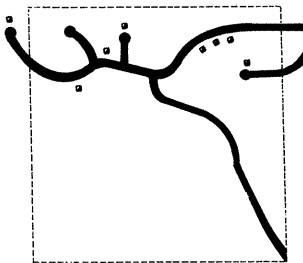
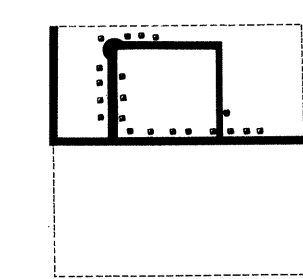

JANUARY 1, 1987