

For line information, see [PM-110](#).

For projects not on the Primary system the following substitutions may be made. See plan sheets for substitutions.

ELW6 → ELW4
 NPY6 → NPY4
 BCY6 → BCY4
 BLW6 → BLW4

① If distance X is less than 3000 feet, omit last R4-3 sign. If distance X is greater than 5250 feet, place R4-3 signs at 2250 foot intervals.

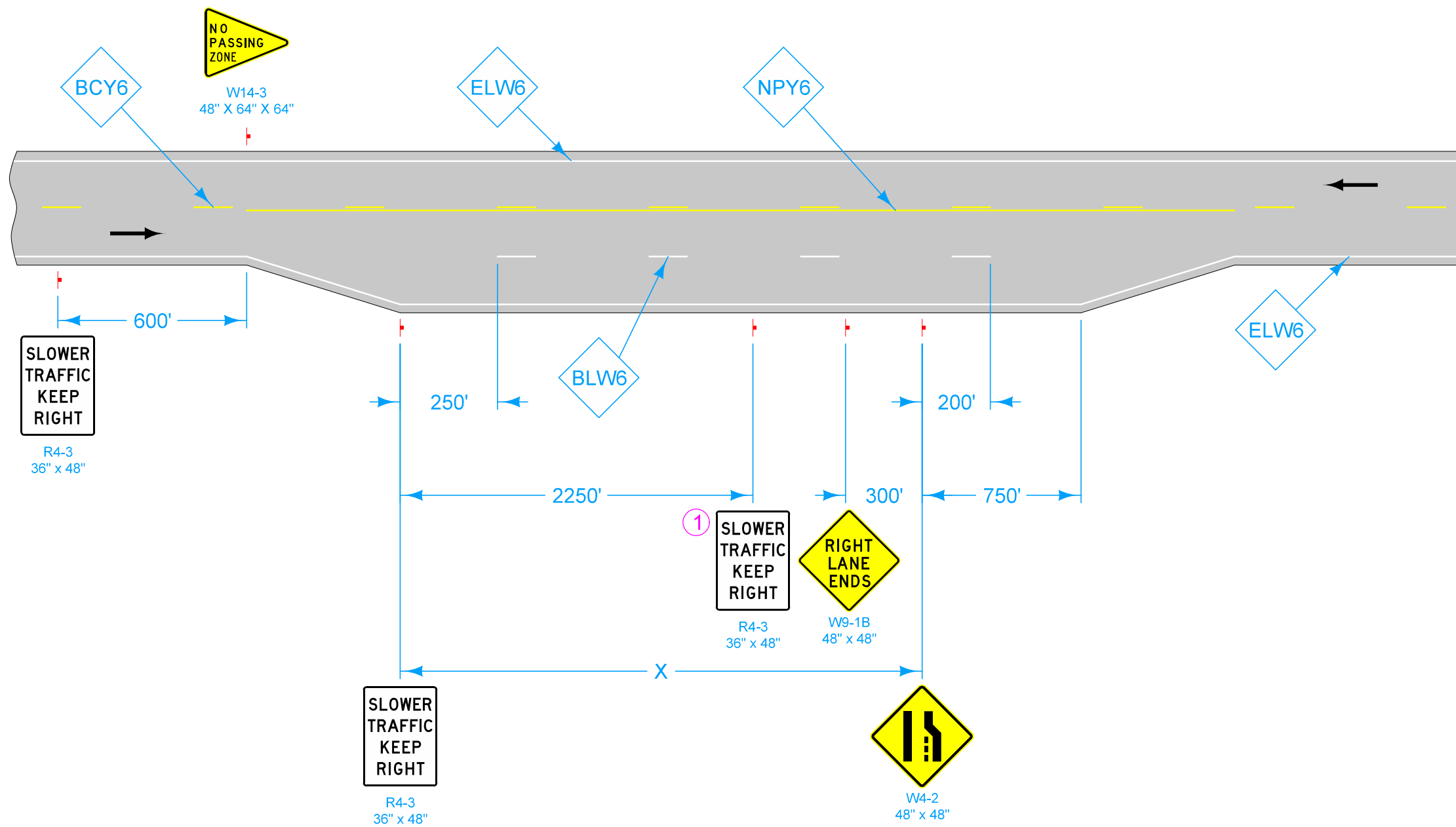

LEGEND

- ← Direction of Traffic
- BCY6 Broken Centerline (Yellow)
- BLW6 Broken Lane Line (White)
- ELW6 Edge Line Right (White)
- NPY6 No Passing Zone Line (Yellow)

Possible Contract Item:
 Pavement Marking Line Items
 Type 'A' Signs

Possible Tabulation:
 108-22

 STANDARD ROAD PLAN	REVISION	
	2	10-15-24
	PM-221	
SHEET 1 of 1		

REVISIONS: Modified line widths from 4 inches to 6 inches.

Steve Miller
 APPROVED BY DESIGN METHODS ENGINEER

CLIMBING LANE