

For joint details, see PV-101.

- ① Build curb to end of Reinforced Bridge Approach Sections. See Curb Location Details (Section B-B on BR-101).
- ② See BR-101.
- ③ Longitudinal Joints (PV-101):
Single Pour - Saw cut joint per Detail B.
Two Pours - Use 'KS-1' joint.
- ④ Excavation limits of Modified Subbase 2 feet outside of pavement edge, see BR-101.
- ⑤ Minimum 2 panels, maximum 3 panels 20 foot panel length. Use 'CD' joints.
- ⑥ The contractor may need to saw cut the HMA pavement full depth to accommodate the 'B' joint.
- ⑦ Place 'RD' joint where PCC shoulder. Place 'B' joint otherwise.

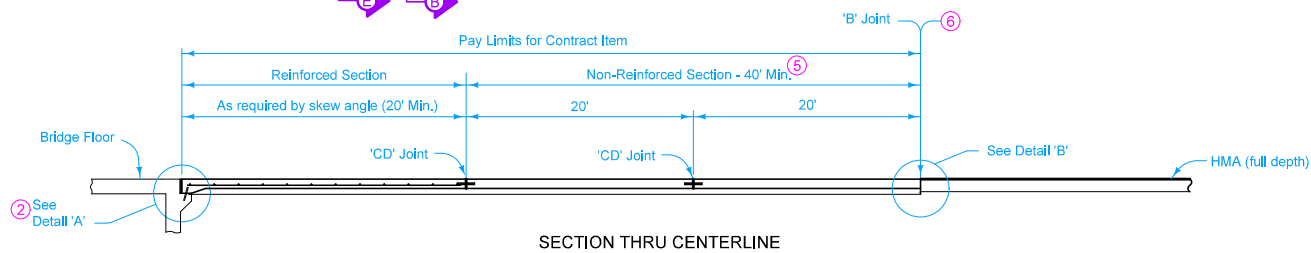

Possible Contract Item:
Bridge Approach, Two Lane

Possible Tabulation:
112-6

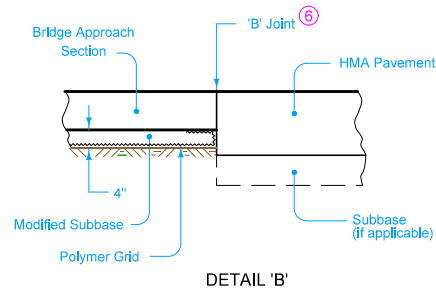
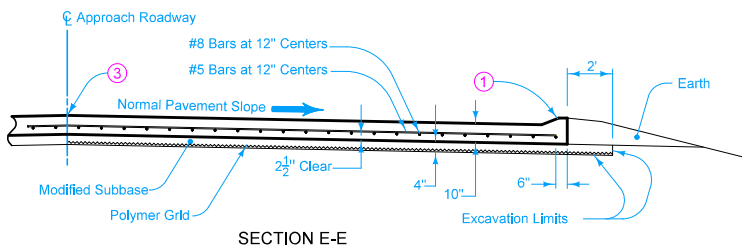

IOWA DOT	REVISION	
	New	04-21-15
STANDARD ROAD PLAN		BR-107
		SHEET 1 of 1

REVISIONS: New. Replaces RK-191.

Brian Smith
APPROVED BY DESIGN METHODS ENGINEER

**BRIDGE APPROACH SECTION
(AT EXISTING BRIDGES, HMA PAVEMENT)**