

**EPOXY COATED REINFORCING BAR LIST, CAST-IN-PLACE ABUTMENT (TWO ABUTMENTS)**

BAR	LOCATION	SPAN	REINFORCED CONCRETE BOX BEAMS									PRETENSIONED PRESTRESSED CONCRETE BOX BEAMS														
			30'-0"			40'-0"			50'-0"			30'-0"			40'-0"			50'-0"			60'-0"			70'-0"		
			NO.	LENGTH	WEIGHT	NO.	LENGTH	WEIGHT	NO.	LENGTH	WEIGHT	NO.	LENGTH	WEIGHT	NO.	LENGTH	WEIGHT	NO.	LENGTH	WEIGHT	NO.	LENGTH	WEIGHT	NO.	LENGTH	WEIGHT
5c1	FOOTING END, VERTICAL	U	16	3'-9"	63	16	3'-9"	63	16	3'-9"	63	16	3'-9"	63	16	3'-9"	63	16	3'-9"	63	16	3'-9"	63	16	3'-9"	63
5c2	FOOTING END, HORIZONTAL	U	16	4'-4"	72	16	4'-4"	72	16	4'-4"	72	16	4'-4"	72	16	4'-4"	72	16	4'-4"	72	16	4'-4"	72	16	4'-4"	72
6d1	BACKWALL, VERTICAL	—	212	4'-4"	1380	212	4'-4"	1380	212	4'-10"	1539	212	3'-10"	1221	212	3'-10"	1221	212	4'-4"	1380	212	4'-4"	1380	212	4'-10"	1539
8f1	FOOTING, LONGITUDINAL	—	24	39'-8"	2542	24	39'-8"	2542	24	39'-8"	2542	24	39'-8"	2542	24	39'-8"	2542	24	39'-8"	2542	24	39'-8"	2542	24	39'-8"	2542
5g1	BACKWALL, HORIZONTAL	—	12	39'-8"	496	12	39'-8"	496	12	39'-8"	496	12	39'-8"	496	12	39'-8"	496	12	39'-8"	496	12	39'-8"	496	12	39'-8"	496
5p1	FOOTING HOOPS	□	144	11'-8"	1752	144	11'-8"	1752	144	11'-8"	1752	144	11'-8"	1752	144	11'-8"	1752	136	11'-8"	1655	136	11'-8"	1655	136	11'-8"	1655
	1/4" DIA. SMOOTH DOWELS	—	16	2'-9"	184	16	2'-9"	184	16	3'-3"	217	16	2'-3"	150	16	2'-3"	150	16	2'-9"	184	16	2'-9"	184	16	3'-3"	217
#2	PILE SPIRAL *	⊘	12	38'-6"	77	12	38'-6"	77	14	38'-6"	90	12	38'-6"	77	12	38'-6"	77	14	38'-6"	90	16	38'-6"	103	16	38'-6"	103
	SPIRAL SPACERS L <sub>1</sub> x L <sub>2</sub> x 0.70 *	—	36	1'-10"	46	36	1'-10"	46	42	1'-10"	54	36	1'-10"	46	36	1'-10"	46	42	1'-10"	54	48	1'-10"	62	48	1'-10"	62
TOTAL (LBS.)			6,612			6,612			6,825			6,419			6,419			6,633			6,557			6,749		

\* EPOXY COATING NOT REQUIRED

**BENT BAR DETAILS**

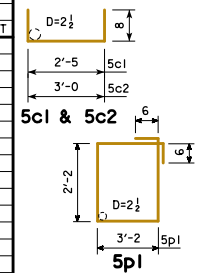

NOTE: ALL DIMENSIONS ARE OUT TO OUT. D= PIN DIAMETER.

**CONCRETE PLACEMENT QUANTITIES (TWO ABUTMENTS)**

LOCATION	SPAN	REINFORCED CONCRETE BOX BEAMS			PRETENSIONED PRESTRESSED CONCRETE BOX BEAMS				
		30'-0"	40'-0"	50'-0"	30'-0"	40'-0"	50'-0"	60'-0"	70'-0"
BACKWALLS (C.Y.)		7.7	7.7	9.3	6.1	6.1	7.7	7.7	9.3
FOOTINGS (C.Y.)		33.2	33.2	33.2	33.2	33.2	33.2	33.2	33.2
TOTAL (C.Y.)		40.9	40.9	42.5	39.3	39.3	40.9	40.9	42.5

LATEST REVISION DATE

APPROVED BY BRIDGE ENGINEER  
*Thomas E. M. Donnell*

**IOWADOT** Highway Division

STANDARD DESIGN - 30'-0" ROADWAY, SINGLE SPAN  
**CONCRETE BOX BEAM BRIDGES**

DECEMBER, 2016

**ABUTMENT DETAILS (CAST-IN-PLACE)**  
SHEET PILE WINGS  
0° SKEW  
(SHEET 2 OF 2)

**B30-11-16**