

For joint details, see [PV-101](#).

- ① Build curb to end of Reinforced Bridge Approach Sections. See Curb Location Details (Section B-B on [BR-101](#)).
- ② See [BR-101](#).
- ③ Longitudinal Joints ([PV-101](#)):
Single Pour - Saw cut joint per Detail B.
Two Pours - Use 'KS-1' joint.
- ④ Excavation limits of Modified Subbase 2 feet outside of pavement edge, see [BR-101](#).
- ⑤ Minimum 2 panels, maximum 3 panels 20 foot panel length. Use 'CD' joints.
- ⑥ The contractor may need to saw cut the HMA pavement full depth to accommodate the 'B' joint.
- ⑦ Place 'RD' joint where PCC shoulder. Place 'B' joint otherwise.

PLAN

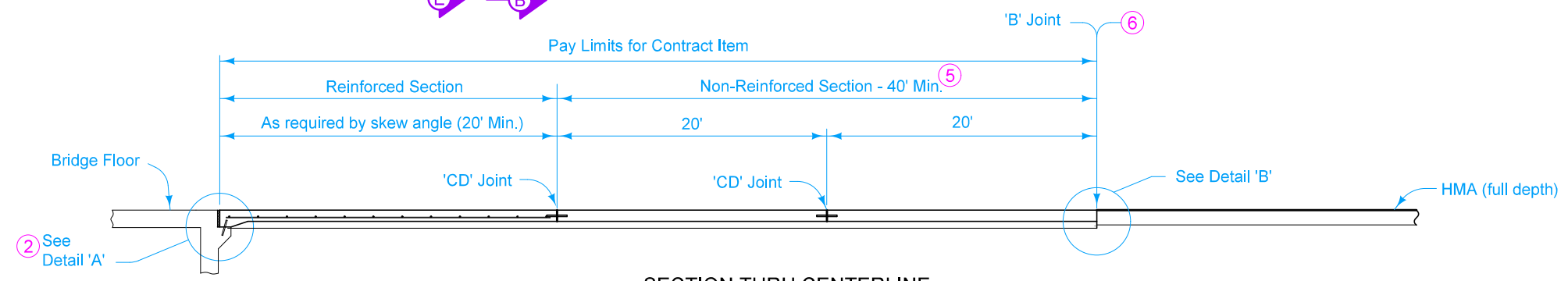

SECTION THRU CENTERLINE

Possible Contract Item:
 Bridge Approach, Two Lane
 Longitudinal Grooving in Concrete, Bridge Deck
 Longitudinal Grooving in Concrete, Pavement

Possible Tabulation:
 112-6

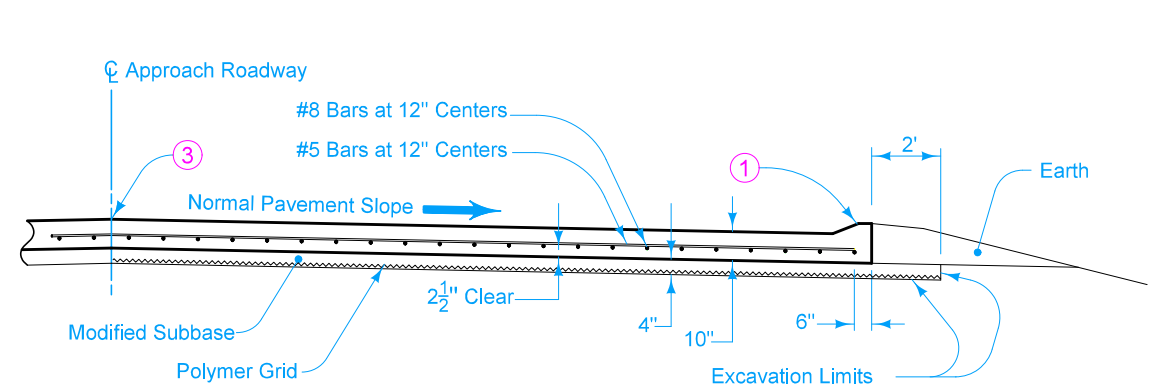

SECTION E-E

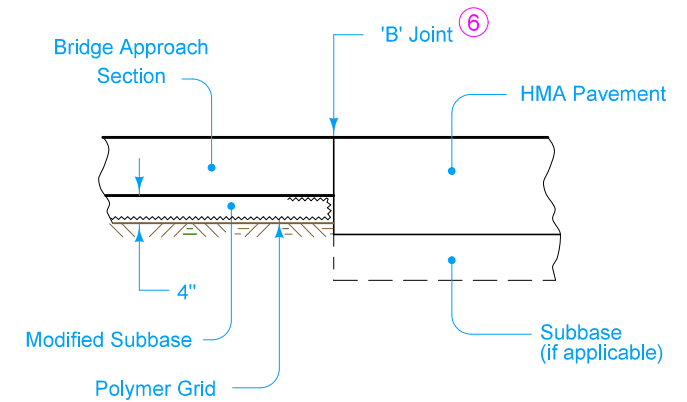

DETAIL 'B'

 STANDARD ROAD PLAN	REVISION	
	1	10-15-24
	BR-107	
SHEET 1 of 1		
REVISIONS: Added Longitudinal Grooving in Concrete to possible contract item.		
 APPROVED BY DESIGN METHODS ENGINEER		
BRIDGE APPROACH SECTION (AT EXISTING BRIDGES, HMA PAVEMENT)		