

Plan View - Top Apron Reinforcing
(Wall Reinforcing not shown for clarity)

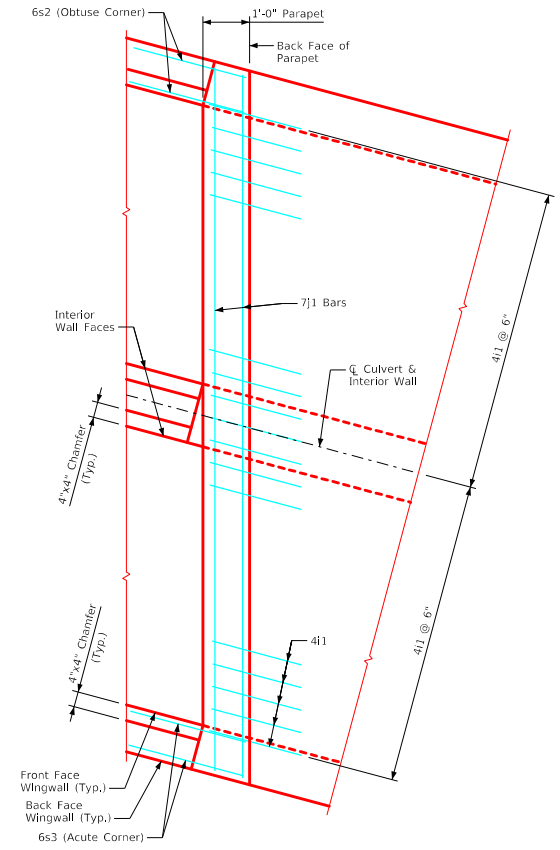

Detail A
(Showing parapet bars only)

Notes:

1. Bar spacings and positions shown are similar for all sizes of headwalls in this standard.
2. For headwall dimensions and bar spacing see Sheet TWPWH 15-1-20.
3. Top transverse apron bars are referenced approximately 4" from the back of the parapet for all headwalls.

LATEST REVISION DATE APPROVED BY BRIDGE ENGINEER		
	Standard Design - Twin Reinforced Concrete Box Culverts Parallel Wing Headwalls July, 2020	
	Parapet Reinforcing & Top Apron Reinforcing 15° Skew	TWPWH 15-5-20