

ENGLISHLRFDDESIGNEDTWINCULVERTS.DGN - TWPWH 45-6-20 - THIS SHEET ISSUED 07-2020.

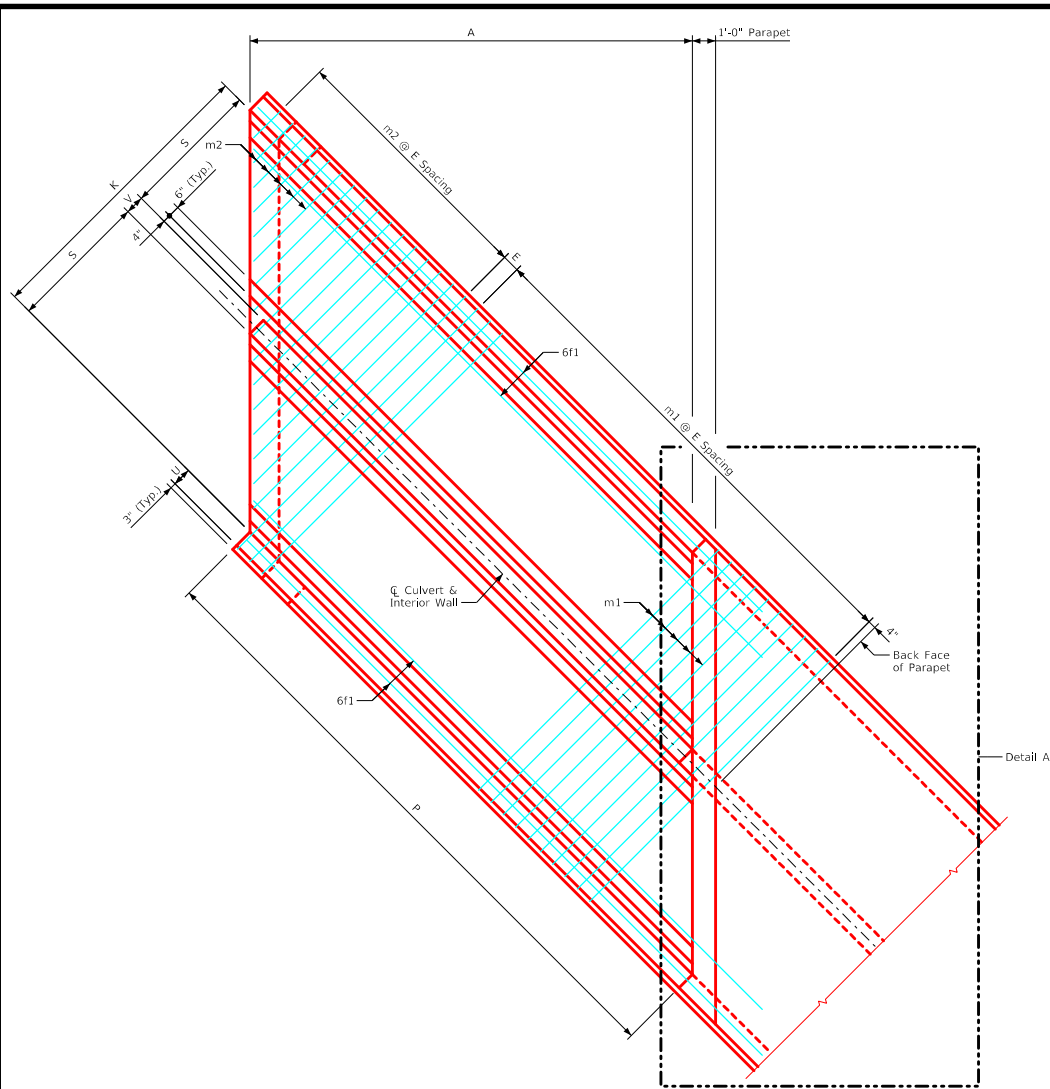

Plan View - Top Apron Reinforcing  
(Wall Reinforcing not shown for clarity)

Notes:

1. Bar spacings and positions shown are similar for all sizes of headwalls in this standard.
2. For headwall dimensions and bar spacing see Sheet TWPWH 45-2-20.
3. Top transverse apron bars are referenced approximately 4" from the back of the parapet for all headwalls.

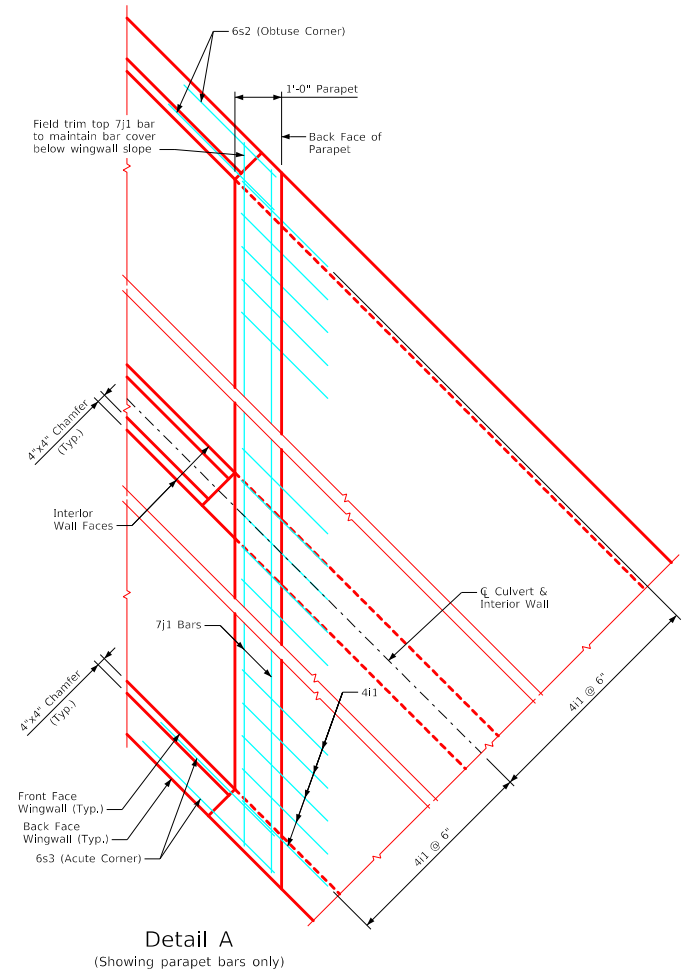

Detail A  
(Showing parapet bars only)

LATEST REVISION DATE	APPROVED BY BRIDGE ENGINEER		
		Standard Design - Twin Reinforced Concrete Box Culverts <b>Parallel Wing Headwalls</b> July, 2020	
		Parapet Reinforcing & Top Apron Reinforcing 45° Skew	TWPWH 45-6-20