

ENGLISHLRFDDESIGNEDTRIPLECULVERTS.DGN - TRPWH 15-4-20 - THIS SHEET ISSUED 07-2020.

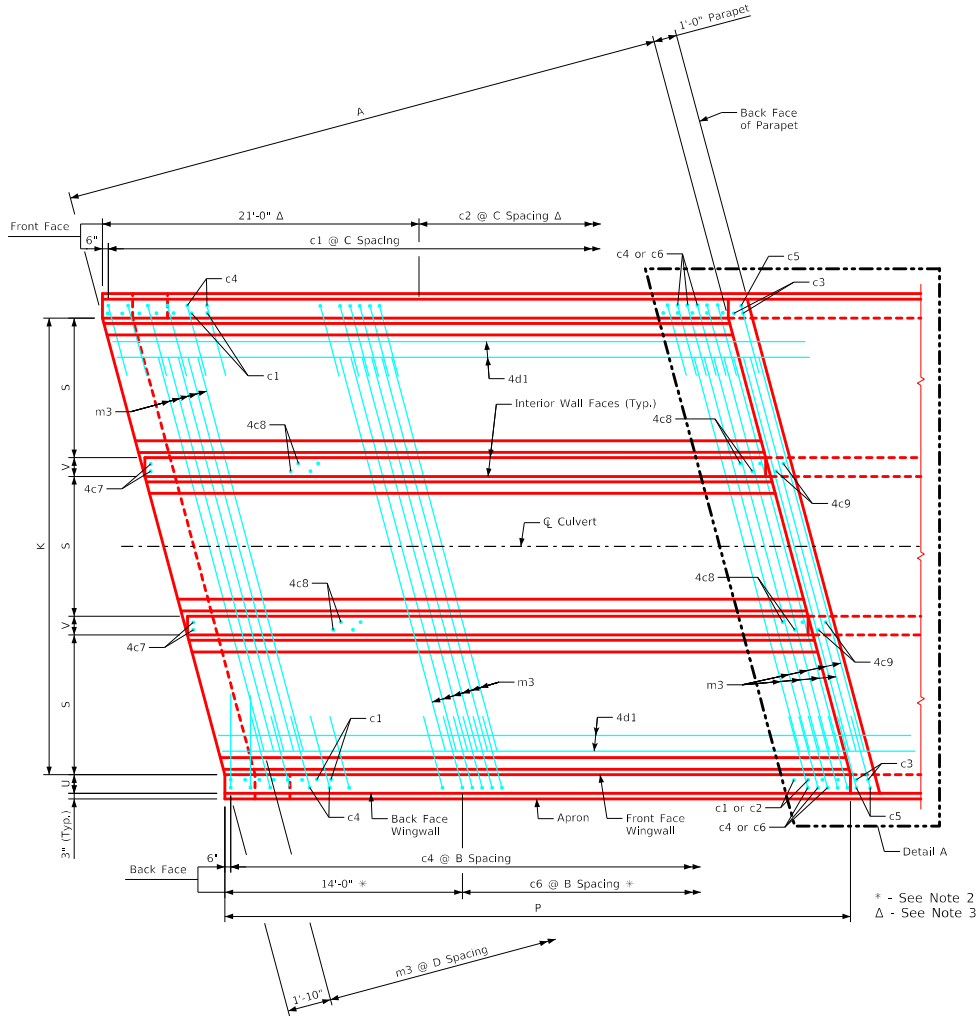

Plan View - Bottom Apron Reinforcing
(Curtain Wall Reinforcing not shown, See Sheet TRPWH 15-2-20)

* - See Note 2
Δ - See Note 3

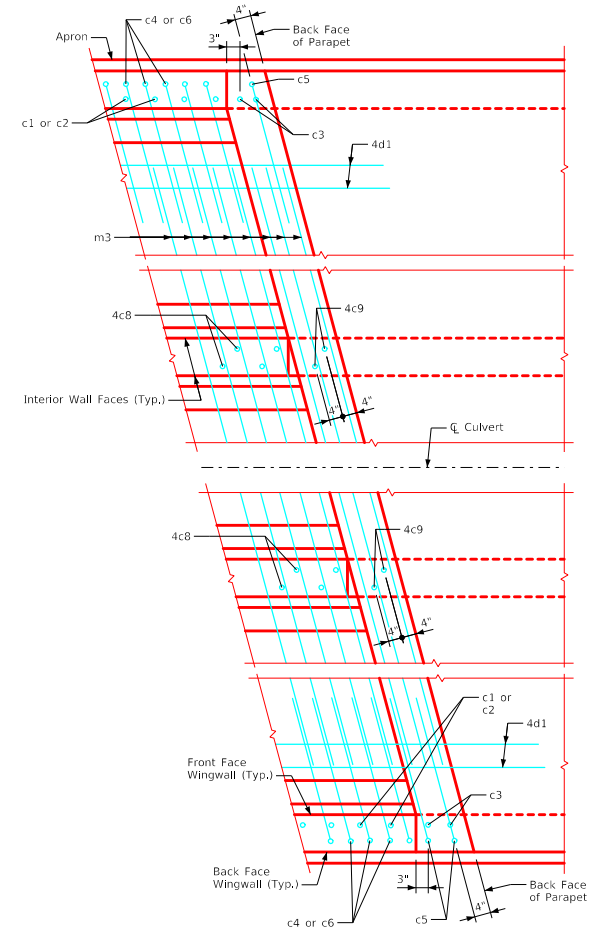

Detail A

Notes:

1. Bar spacings and positions shown are similar for all sizes of headwalls in this standard.
2. Not applicable for 4' & 5' height headwalls.
3. Not applicable for 4' thru 8' height headwalls.
4. For headwall dimensions and bar spacing see Sheet TRPWH 15-1-20.
5. Apron m3 bars are to be centered on ϕ culvert.
6. B.F.V. (c5), F.F.V. (c3) and interior wall both F.V. (c9) bars are approximately 4" from the back of parapet for all headwalls.

LATEST REVISION DATE APPROVED BY BRIDGE ENGINEER 	Standard Design - Triple Reinforced Concrete Box Culverts Parallel Wing Headwalls July, 2020	
	Bottom Apron Reinforcing 15° Skew	TRPWH 15-4-20