

SIGNS FACING TRAFFIC APPROACHING FROM THE REAR

**OUTSIDE EDGELINE OR LANELINE - DIVIDED OR UNDIVIDED**

Possible Contract Item:  
Traffic Control

Equip all vehicles with an amber revolving light or and amber strobe light.

- ① Optional Fluorescent Yellow Green (FYG) sign background may be used.
- ② This arrow display may be operated in a four-corner caution mode.
- ③ A vehicle-mounted Changeable Message Sign (CMS) may be used in lieu of this sign.
- ④ Refer to [SI-881](#) for sign details.

**LEGEND**

← Direction of Traffic

▣ Truck-Mounted Attenuator (TMA)

|  |  |
|--|--|
| <p>Iowa Department of Transportation</p> <p><b>STANDARD ROAD PLAN</b></p> <p>REVISIONS: Added additional layouts for pavement marking operations.</p> <p><i>Deanna McFalls</i><br/>APPROVED BY DESIGN METHODS ENGINEER</p> <p><b>PAVEMENT MARKING OPERATIONS</b></p> | <p>REVISION</p> <p>1 04-19-11</p>        |
|  | <p><b>TC-433</b></p> <p>SHEET 1 of 3</p> |

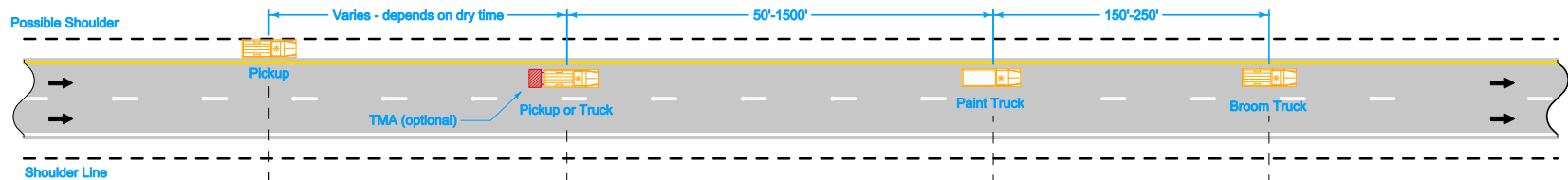

SIGNS FACING TRAFFIC  
APPROACHING FROM  
THE REAR

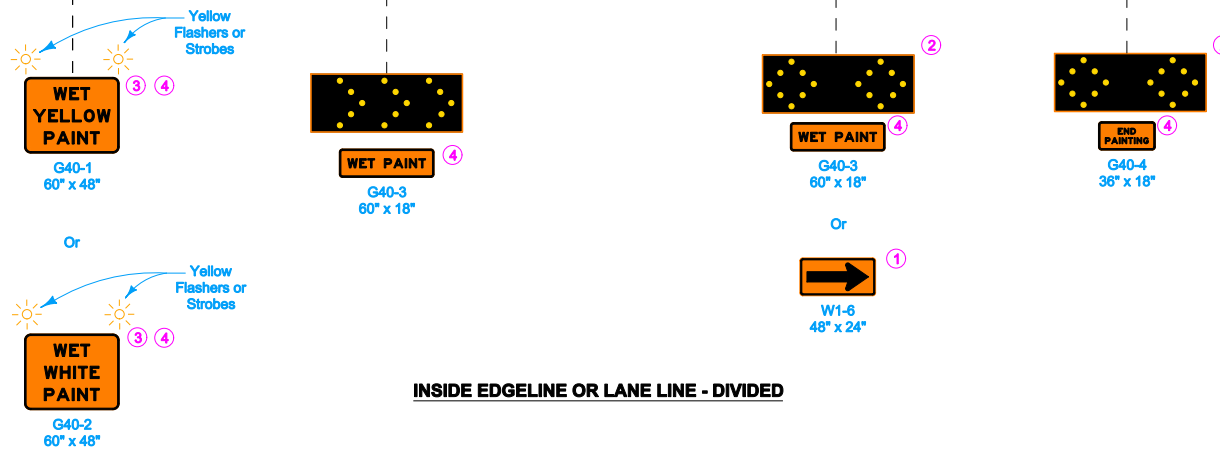

**INSIDE EDGELINE OR LANE LINE - DIVIDED**

- ① Optional Fluorescent Yellow Green (FYG) sign background may be used.
- ② This arrow display may be operated in a four-corner caution mode.
- ③ A vehicle mounted Changeable Message Sign (CMS) may be used in lieu of this sign.
- ④ Refer to [SI-881](#) for sign details.

**LEGEND**

← Direction of Traffic

▣ Truck-Mounted Attenuator (TMA)

|  |   |          |          |
|--|---|----------|----------|
| <p>Iowa Department of Transportation</p> <p><b>STANDARD ROAD PLAN</b></p> <p>REVISIONS: Added additional layouts for pavement marking operations.</p> <p><i>Deanna McFalls</i><br/>APPROVED BY DESIGN METHODS ENGINEER</p> <p><b>PAVEMENT MARKING OPERATIONS</b></p> | <p>REVISION</p> <table border="1"> <tr> <td>1</td> <td>04-19-11</td> </tr> </table> | 1        | 04-19-11 |
|  | 1   | 04-19-11 |          |
| <p><b>TC-433</b></p> <p>SHEET 2 of 3</p>   |   |          |          |

SIGNS FACING  
OPPOSING TRAFFIC

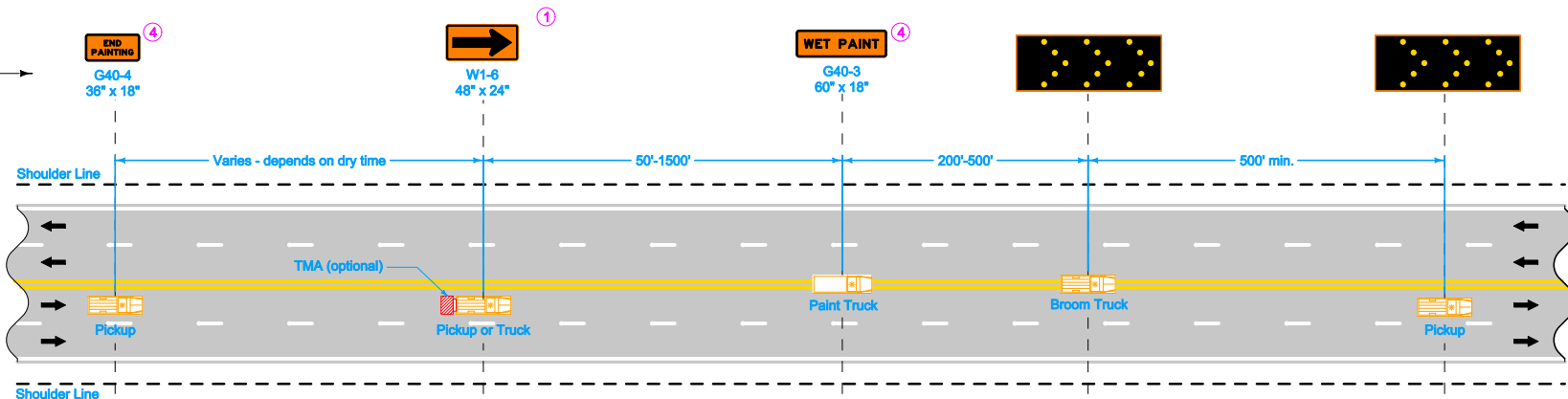

SIGNS FACING TRAFFIC  
APPROACHING FROM  
THE REAR

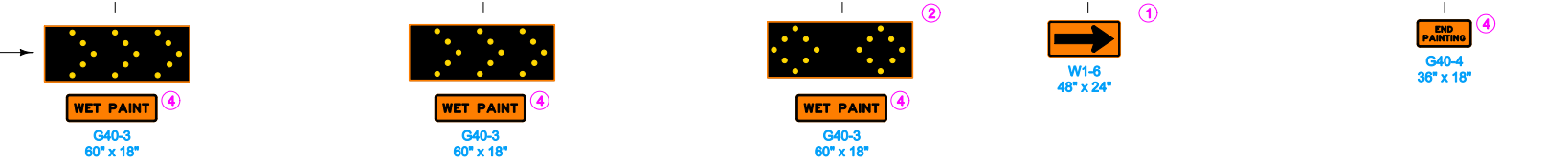

**CENTERLINE - UNDIVIDED ONLY**

- ① Optional Fluorescent Yellow Green (FYG) sign background may be used.
- ② This arrow display may be operated in a four-corner caution mode.
- ④ Refer to SI-881 for sign details.

**LEGEND**

← Direction of Traffic

▧ Truck-Mounted Attenuator (TMA)

|  |  |
|--|--|
| <p>Iowa Department of Transportation</p> <p><b>STANDARD ROAD PLAN</b></p> <p>REVISIONS: Added additional layouts for pavement marking operations.</p> <p><i>Deanna McFalls</i><br/>APPROVED BY DESIGN METHODS ENGINEER</p> <p><b>PAVEMENT MARKING OPERATIONS</b></p> | <p>REVISION</p> <p>1 04-19-11</p>        |
|  | <p><b>TC-433</b></p> <p>SHEET 3 of 3</p> |