

ROAD WORK AHEAD
W20-1
48" x 48"

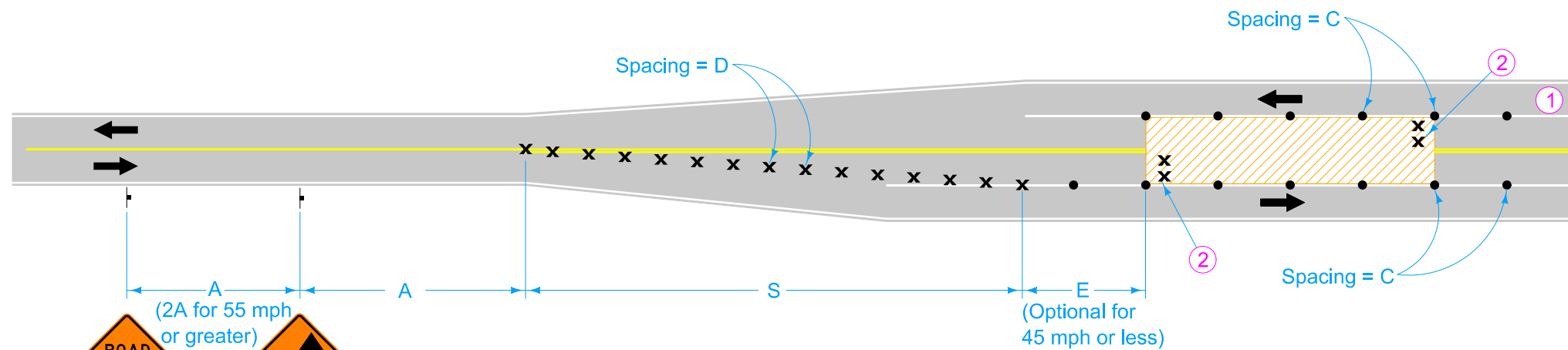

ROAD WORK AHEAD
W20-1
48" x 48"

LANE SHIFT
W1-4R
48" x 48"

Possible Contract Item:
Traffic Control

LEGEND

- † Traffic Sign
- 42" Channelizer
- × Drum
- ▨ Work Area
- ← Direction of Traffic

SPEED LIMIT (mph)*	A	C	D	E	S
25 or less	100'	40'	25'	0'-200'	100'
30 - 35	250'	40'	30'	0'-200'	120'
40 - 50	350'	80'	40'	0'-400'	280'
55 or greater	500'	100'	50'	200'-400'	350'

* Speed Limit refers to regulatory speed limit before road work.

- ① Refer to TC-419 for lane closure details.
- ② For lanes closed to traffic, place two drums every 1000 feet. For full depth excavations in a closed lane, place two drums in front of each location. Additional drums need not be placed for full depth excavations spaced closer than 150 feet.

Possible Contract Item:
Traffic Control

 STANDARD ROAD PLAN	REVISION	
	<table border="1" style="width: 100%; border-collapse: collapse;"> <tr> <td style="width: 10px; text-align: center;">4</td> <td style="width: 10px; text-align: center;">4-18-23</td> </tr> </table>	4
4	4-18-23	
TC-63		
SHEET 1 of 1		
REVISIONS: Added speed limit note. Formatted speed limit table.		
 <small>APPROVED BY DESIGN METHODS ENGINEER</small>		
LANE CLOSURE AT TWO-LANE TO FOUR-LANE TRANSITION		