

R-22W

9

355TH ST

28

27

26

9

EAGLE AVE



LEGEND

- INTERSTATE ROUTE
- FREEWAY OR EXPRESSWAY ROUTE
- U.S. NUMBERED ROUTE
- BUSINESS ROUTE
- STATE NUMBERED ROUTE
- UNSIGNED ROUTE
- COUNTY NUMBERED ROUTE
- SECONDARY ROAD OR ADJOINING CITY STREET
- CITY STREET
- PARK, INSTITUTION, OR FEDERAL ROAD
- RAILROAD
- CORPORATION LINE
- SECTION LINE
- CUL-DE-SAC
- SECTION, TOWNSHIP & RANGE NUMBERS

SCALE IN MILES

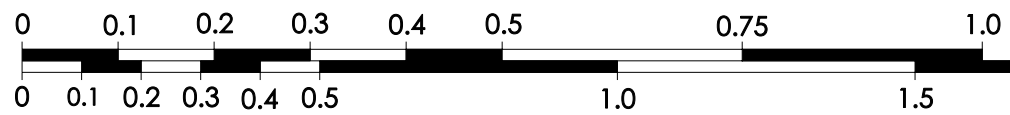

SCALE IN KILOMETERS

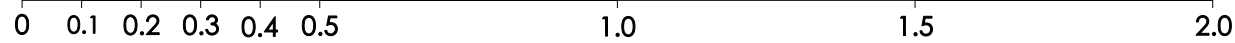

HIGHWAY AND STREET MAP OF

FERTILE IOWA

PREPARED BY

IOWA DEPARTMENT OF TRANSPORTATION  
PLANNING, PROGRAMMING, AND MODAL DIVISION  
OFFICE OF TRANSPORTATION DATA

PHONE (515) 239-1289

IN COOPERATION WITH

UNITED STATES DEPARTMENT OF TRANSPORTATION  
FEDERAL HIGHWAY ADMINISTRATION

98-2547

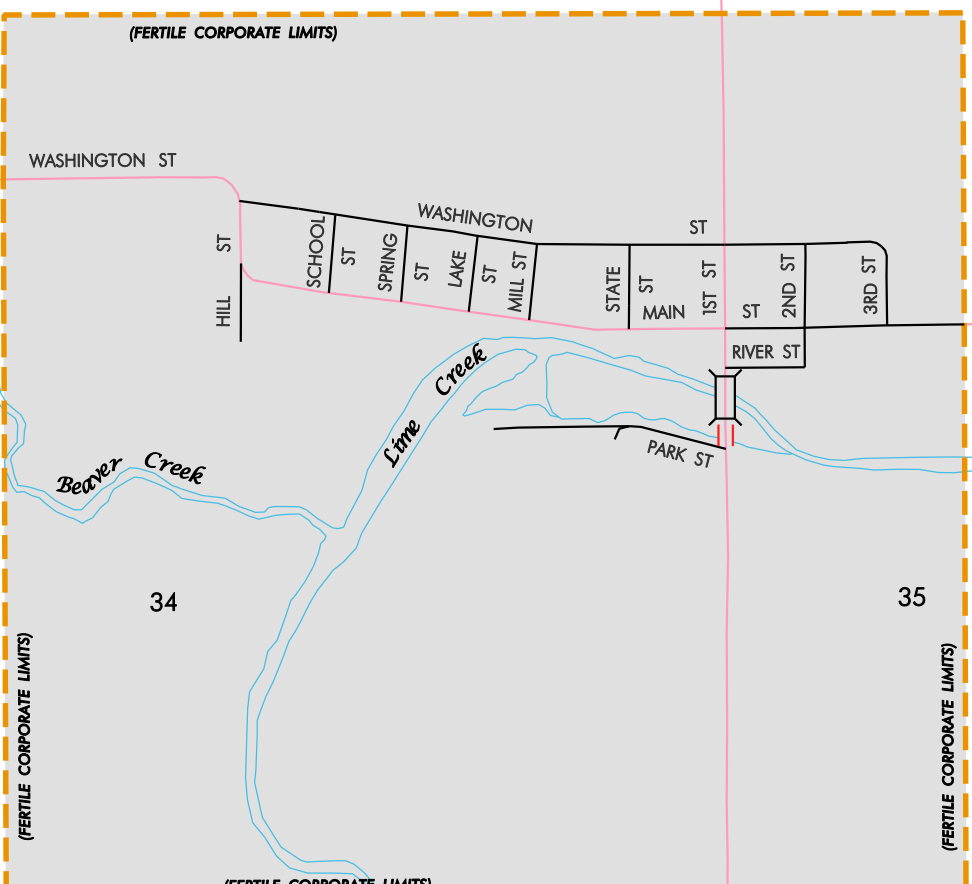

WORTH COUNTY  
CERRO GORDO COUNTY